

| COM | | |
|------|---------|----------------------|
| ATIS | 125.855 | SUMBURGH INFORMATION |
| TWR | 118.255 | SUMBURGH TOWER |
| | 121.600 | SUMBURGH FIRE CHIEF |
| AFIS | 118.255 | SUMBURGH INFORMATION |

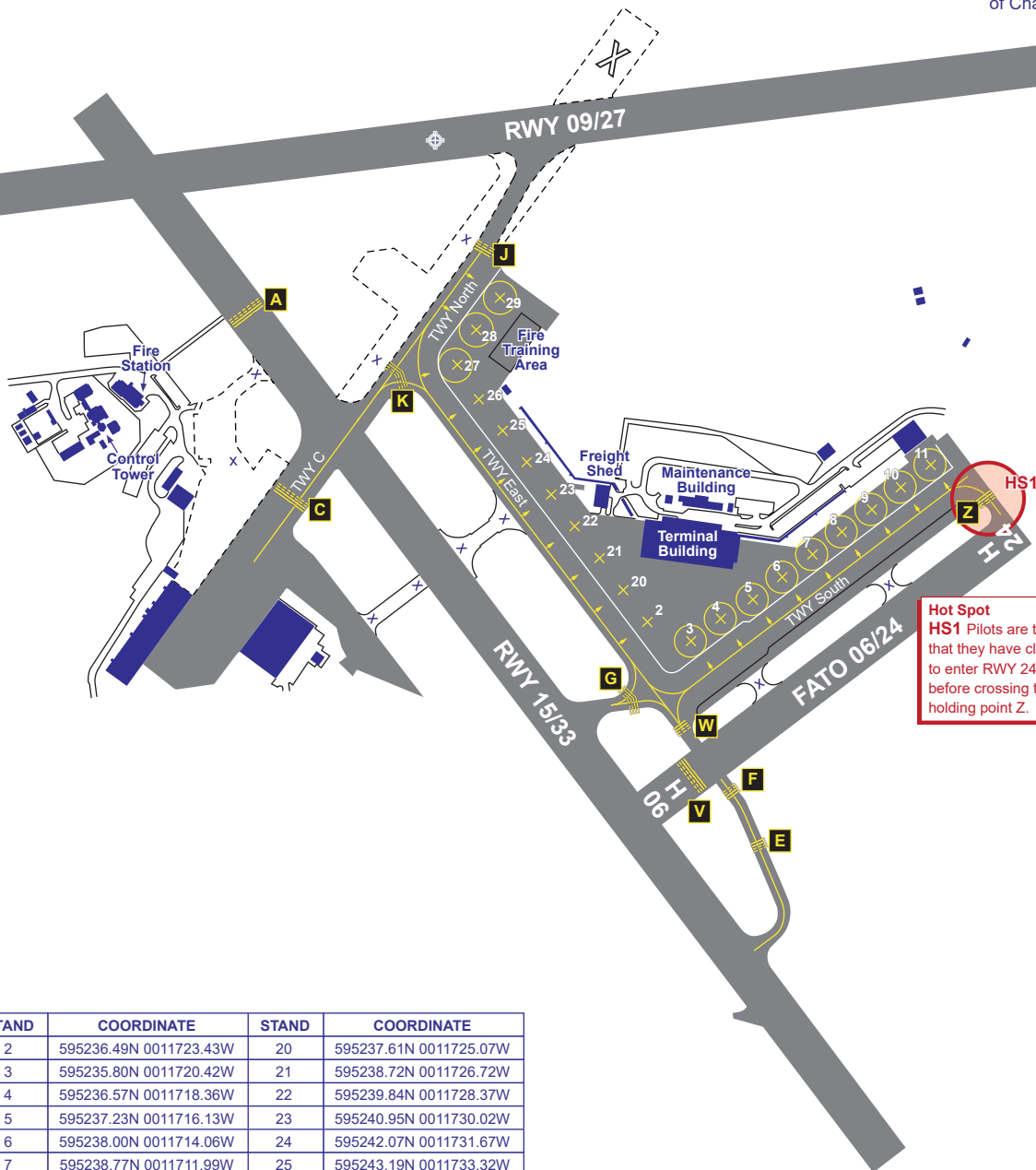
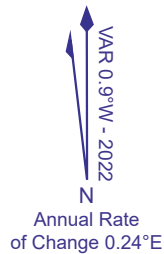
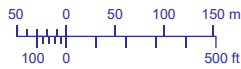

Hot Spot
HS1 Pilots are to ensure that they have clearance to enter RWY 24 (Heli) before crossing the holding point Z.

| STAND | COORDINATE | STAND | COORDINATE |
|-------|------------------------|-------|------------------------|
| 2 | 595236.49N 0011723.43W | 20 | 595237.61N 0011725.07W |
| 3 | 595235.80N 0011720.42W | 21 | 595238.72N 0011726.72W |
| 4 | 595236.57N 0011718.36W | 22 | 595239.84N 0011728.37W |
| 5 | 595237.23N 0011716.13W | 23 | 595240.95N 0011730.02W |
| 6 | 595238.00N 0011714.06W | 24 | 595242.07N 0011731.67W |
| 7 | 595238.77N 0011711.99W | 25 | 595243.19N 0011733.32W |
| 8 | 595239.54N 0011709.93W | 26 | 595244.30N 0011734.97W |
| 9 | 595240.31N 0011707.86W | 27 | 595245.49N 0011736.42W |
| 10 | 595241.08N 0011705.80W | 28 | 595246.71N 0011735.05W |
| 11 | 595241.85N 0011703.74W | 29 | 595247.82N 0011733.40W |

| RUNWAY/TAXIWAY/APRON PHYSICAL CHARACTERISTICS | | | | |
|---|-------------------|------------|-----|-----------|
| APRON / RWY / TWY | SURFACE | PCN | PCR | ELEVATION |
| Terminal East | Concrete | 29/R/B/W/T | - | - |
| Terminal West | Concrete | 16/R/B/W/T | - | - |
| RWY (All) | See AD 2-EGPB-2-1 | | | |
| TWY (All) | | | | |